

1 FIRST FLOOR - AREA DIAGRAM ADDITION
SCALE 1:200

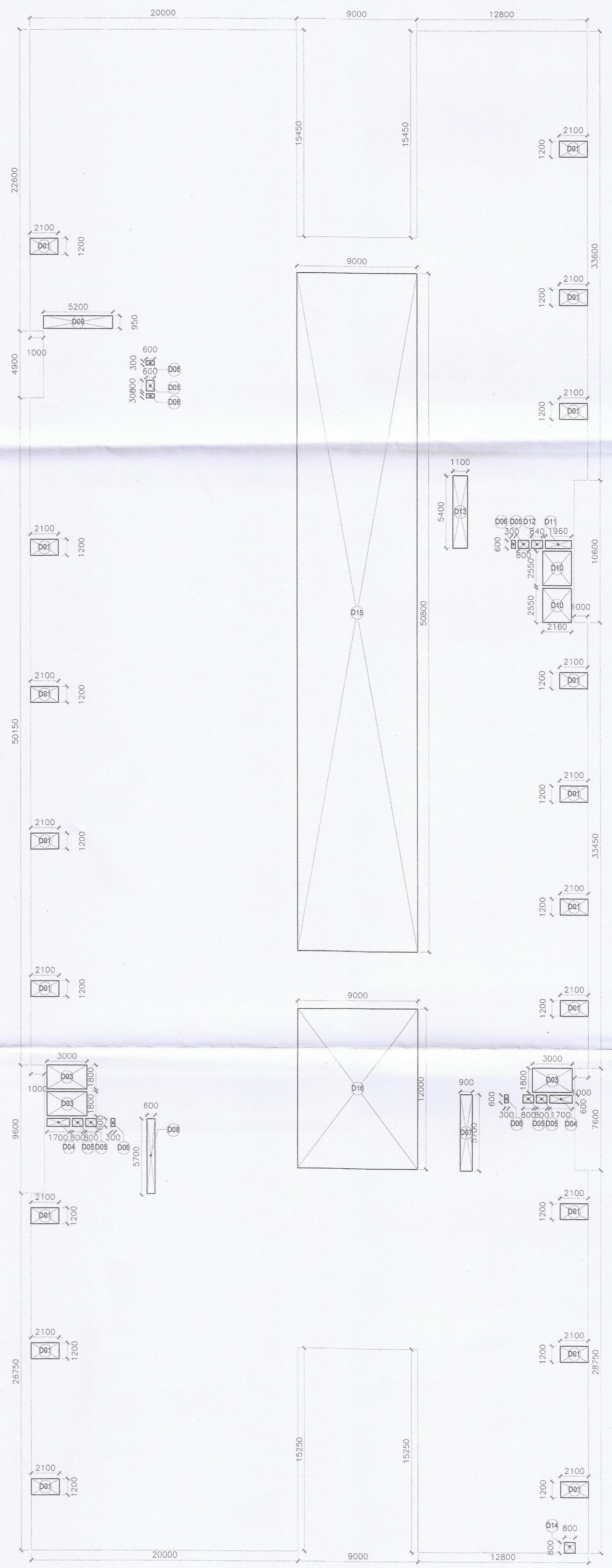

2 FIRST FLOOR - AREA DIAGRAM DEDUCTION
SCALE 1:200

FLOOR AREA RATIO (FAR) CALCULATION- FIRST FLOOR (TABLE-06)						
S.NO.	DESCRIPTION	QUANTITY	X	Y	FORMULA	AREA (SQ. M.)
1	A01	1	20,000	22,600	Area Rectangle= L X B	452,000
2	A02	1	40,800	4,900	Area Rectangle= L X B	199,920
3	A03	1	41,800	6,100	Area Rectangle= L X B	254,980
4	A04	1	40,800	10,600	Area Rectangle= L X B	432,480
5	A05	1	41,800	33,450	Area Rectangle= L X B	1,398,210
6	A06	1	28,000	9,600	Area Rectangle= L X B	268,800
7	A07	1	11,800	7,600	Area Rectangle= L X B	89,680
8	A08	1	20,000	26,750	Area Rectangle= L X B	535,000
9	A09	1	9,000	11,500	Area Rectangle= L X B	103,500
10	A10	1	12,800	28,750	Area Rectangle= L X B	368,000
11	A11	1	9,000	7,150	Area Rectangle= L X B	64,350
12	A12	1	12,800	22,600	Area Rectangle= L X B	289,280
A TOTAL ADDITION AREA OF FIRST FLOOR (A)						4456.200

S.NO.	DESCRIPTION	QUANTITY	X	Y	FORMULA	AREA (SQ. M.)
1	D01	17	2,100	1,200	Area Rectangle= L X B	42,840
2	D02	1	2,100	0,800	Area Rectangle= L X B	1,680
3	D03	3	3,000	1,800	Area Rectangle= L X B	16,200
4	D04	2	1,700	0,600	Area Rectangle= L X B	2,040
5	D05	6	0,800	0,600	Area Rectangle= L X B	2,880
6	D06	5	0,300	0,600	Area Rectangle= L X B	0,900
7	D07	1	0,900	5,700	Area Rectangle= L X B	5,130
8	D08	1	0,600	5,700	Area Rectangle= L X B	3,420
9	D09	1	5,200	0,950	Area Rectangle= L X B	4,940
10	D10	2	2,160	2,550	Area Rectangle= L X B	11,016
11	D11	1	1,960	0,600	Area Rectangle= L X B	1,176
12	D12	1	0,840	0,600	Area Rectangle= L X B	0,504
13	D13	1	1,100	5,400	Area Rectangle= L X B	5,940
14	D14	1	0,800	0,800	Area Rectangle= L X B	0,640
15	D15	1	9,000	50,800	Area Rectangle= L X B	457,200
16	D16	1	9,000	12,000	Area Rectangle= L X B	108,000
B TOTAL DEDUCTION AREA ON FIRST FLOOR (B)						664,506
C NET FAR AREA ON FIRST FLOOR (C=A-B)						3791,694

03/14/24
Sub-Assistant Engineer (P&RD)
Jalpaiguri Zilla Parishad
Assistant Engineer (P&RD)
Jalpaiguri Zilla Parishad
District Engineer
Jalpaiguri Zilla Parishad

PROJECT CODE: 209

- This Drawing and Design is the Property of the Designers. No Portion may be used or Reproduced without their Written Permission.
- All Dimensions are to be Verified onsite by the Contractor. Any Discrepancies are to be Reported to the Designers Immediately.
- This Drawing is to be Read in Conjunction with the Designers Specifications, Conditions of Contract and Relevant Consultant Drawings.
- Drawings not Showing the Latest Revisions are to be Cancelled.
- All Dimensions are to be Read not Scaled.
- All Indicated Levels are Finished Levels unless Noted Otherwise.
- Architect is not responsible for any deviation in areas (built, structural, marketing etc)
- Any and All deviations from municipal drawings is understood to be made of behalf of client request with prior information provided to the client by architect about legal implications. Architect in no way whatsoever can be held responsible for such deviations.
- All fire fighting arrangements are kept as per latest NBC.

SPECIAL NOTE:
1. THE BUILDING IS FULLY MILD-STEEL VENTILATED.
2. THIS BUILDING IS FULLY EQUIPPED WITH SPRINKLER SYSTEMS.
3. ALL EXPOSED SURFACES, LIFT LOBBY AND LIFT SHAFTS ARE PRESERVED.

SCHEDULE OF LAND:
MUDA KRISHAN NO. 1817/93/12, 16/0
P.O. NO. 1817/93/12, 16/0
SERIAL NO. 1817/93/12, 16/0
SCHEME NO. 1817/93/12, 16/0
J.L. NO. 1817/93/12, 16/0
SITE NO. 1817/93/12, 16/0
BLOCK 1817/93/12, 16/0
JALPAIGURI
DIST. NEW JALPAIGURI

STRUCTURE CONSULTANT:
ADROIT CONSULTANT
12/3 PANCHAMANTALA MAIN ROAD, KOLKATA - 700029

MEP/SERVICE CONSULTANT:
UDAYAN CHAUDHARI & ASSOCIATES
40/80, 2ND FLOOR, CHITARANJAN PARK, NEW DELHI-110019

DECLARATION OF GEO-TECHNICAL ENGINEER:
I, THE UNDERSIGNED, HAVE CONDUCTED SOIL EXPLORATION AND RECOMMENDATION OF SOIL BEARING CAPACITY HAS BEEN STRICTLY ACCORDING TO THE LATEST RELEVANT IS CODES AND I AM NOT RESPONSIBLE FOR THE CONSTRUCTION OF THE BUILDING.

DECLARATION OF ARCHITECT:
I, THE UNDERSIGNED, HAVE PREPARED THIS PLAN AND SPECIFICATIONS AND I AM NOT RESPONSIBLE FOR THE CONSTRUCTION OF THE BUILDING.

DECLARATION OF STRUCTURAL ENGINEER:
I, THE UNDERSIGNED, HAVE PREPARED THE STRUCTURAL DESIGN, ESTIMATION AND SUPERSTRUCTURE OF THE BUILDING AND I AM NOT RESPONSIBLE FOR THE CONSTRUCTION OF THE BUILDING.

DECLARATION OF CIVIL ENGINEER:
I, THE UNDERSIGNED, HAVE PREPARED THE CIVIL DESIGN AND I AM NOT RESPONSIBLE FOR THE CONSTRUCTION OF THE BUILDING.

FOR SOIL ONLY

DECLARATION OF ARCHITECT:
I, THE UNDERSIGNED, HAVE PREPARED THIS PLAN AND SPECIFICATIONS AND I AM NOT RESPONSIBLE FOR THE CONSTRUCTION OF THE BUILDING.

DECLARATION OF STRUCTURAL ENGINEER:
I, THE UNDERSIGNED, HAVE PREPARED THE STRUCTURAL DESIGN, ESTIMATION AND SUPERSTRUCTURE OF THE BUILDING AND I AM NOT RESPONSIBLE FOR THE CONSTRUCTION OF THE BUILDING.

DECLARATION OF CIVIL ENGINEER:
I, THE UNDERSIGNED, HAVE PREPARED THE CIVIL DESIGN AND I AM NOT RESPONSIBLE FOR THE CONSTRUCTION OF THE BUILDING.

PROJECT TITLE/INFORMATION:
1. ESTIMATION AND SUPERSTRUCTURE OF THE BUILDING.
2. ESTIMATION AND SUPERSTRUCTURE OF THE BUILDING.
3. ESTIMATION AND SUPERSTRUCTURE OF THE BUILDING.

REVISIONS:

REV. NO.	DATE	REMARKS

LOCATION:
UDOHARA, PHASE-I, KARAKHAR, DIST- JALPAIGURI

DRAWING TITLE:
FIRST FLOOR PLAN

DRAWING STATUS:
SANCTION DWG.

PROJECT STARTED: 2023 SCALE: 1:200

CHECKED: RAHUL DEALT, RAMZAN

DRAWING NO. A-1.3A

13 DEC, 2023

HILLVIEW LEISURE PVT. LTD.
DIRECTOR
SUMAN MFG. WORKS LTD.
Vijay Bansal
DIRECTOR